

INSTALLATION & MAINTENANCE MANUAL

ASH100 ROLLING SHUTTER

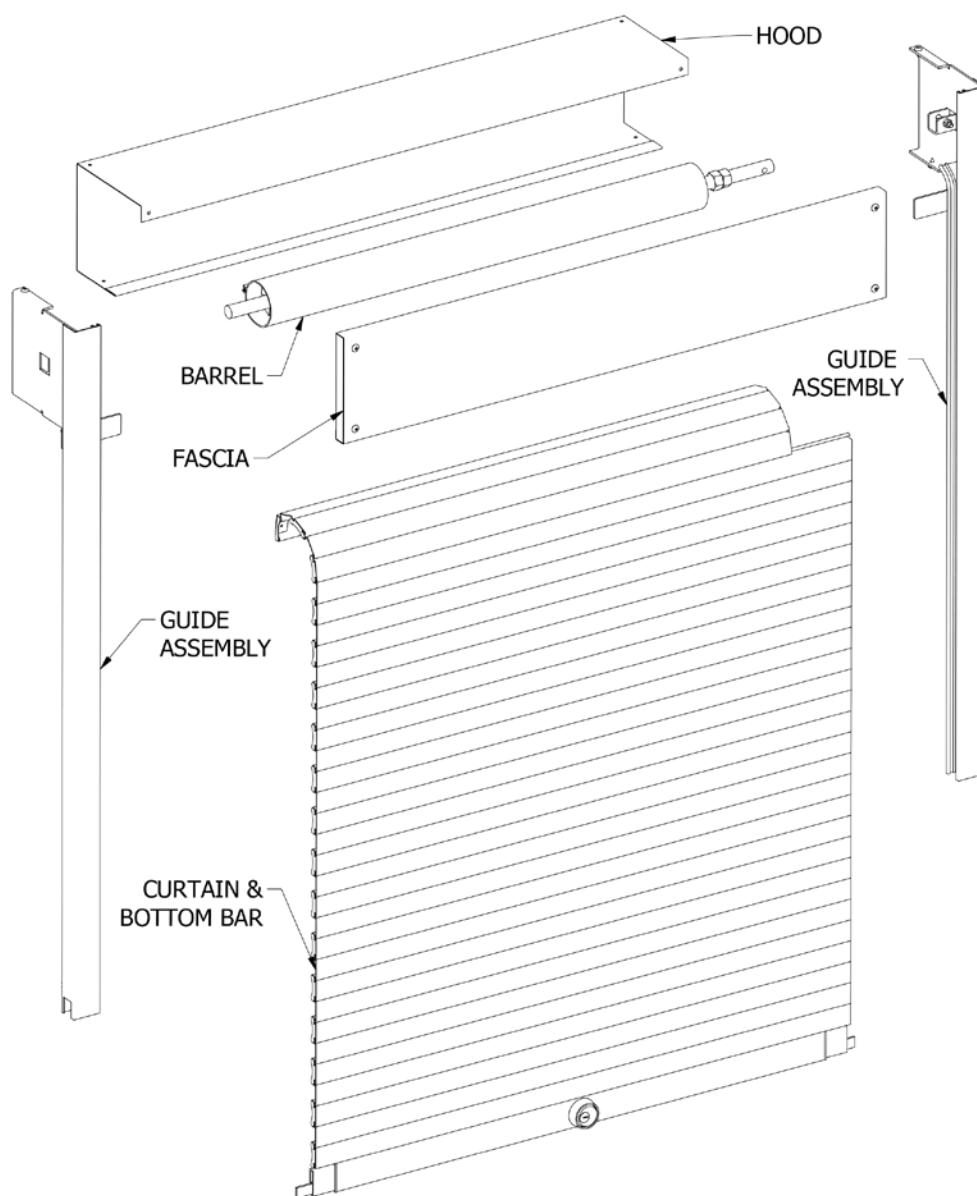

EQUIPMENT REQUIRED FOR INSTALLATION

- 1X PERSONAL PROTECTIVE EQUIPMENT (PPE)
- 1X MEASURING TAPE
- 1X LEVEL / LASER LEVEL
- 1X CORDLESS DRILL
- 1X DRILL BIT 11/64"
- 1X ALLEN KEY 5/32"
- 2X WRENCHES 3/4"
- 1X ROBERTSON DRIVER BIT #2

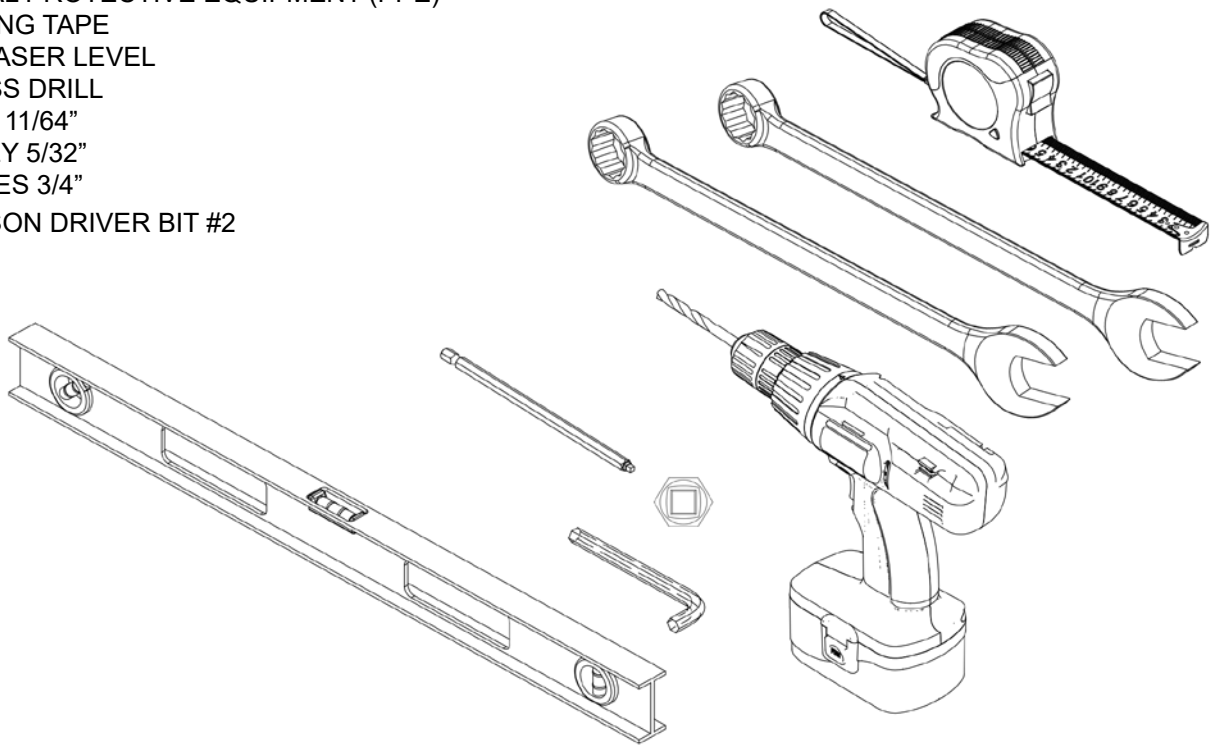

STEP BY STEP INSTALLATION INSTRUCTIONS

1 CHECK OPENING DIMENSIONS AGAINST AS BUILT DRAWINGS

2 CHECK THAT COUNTER AND WALLS OF THE INSTALLATION SURFACE ARE LEVEL. ADJUST GUIDES ACCORDINGLY DURING INSTALLATION TO ENSURE A PROPER INSTALLATION.

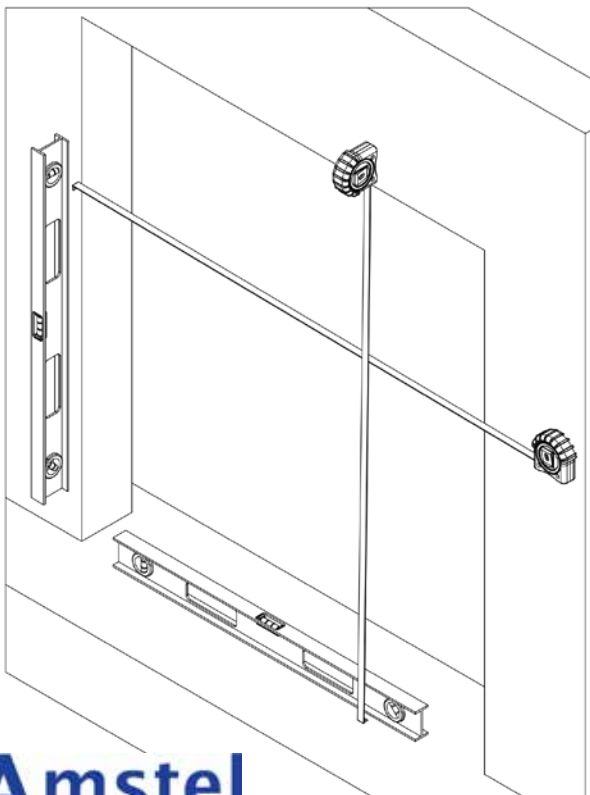

FACE OF WALL MOUNTING

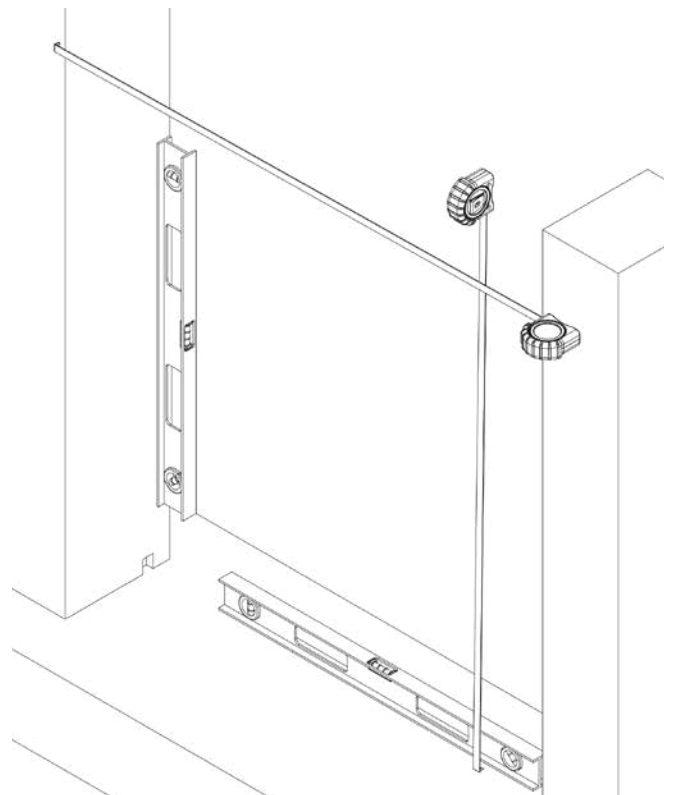

BETWEEN JAMB MOUNTING

3

INSTALL GUIDE ASSEMBLY FLUSH TO WALL AND PLUMB. MOUNTING SUPPORT AND DISTANCE BETWEEN GUIDES MUST MATCH THE AS BUILT DRAWINGS

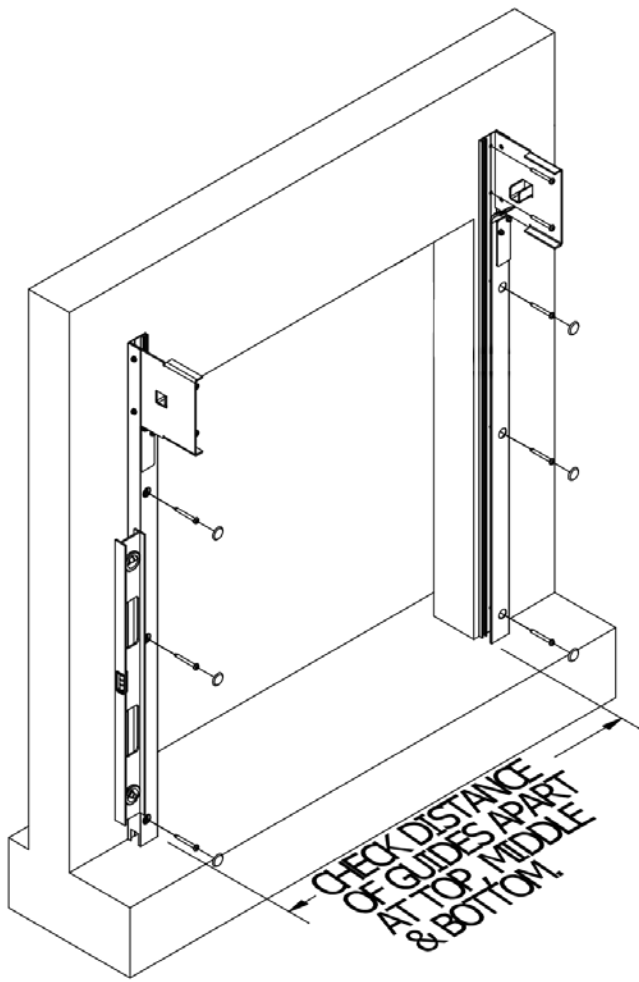

FACE OF WALL MOUNTING

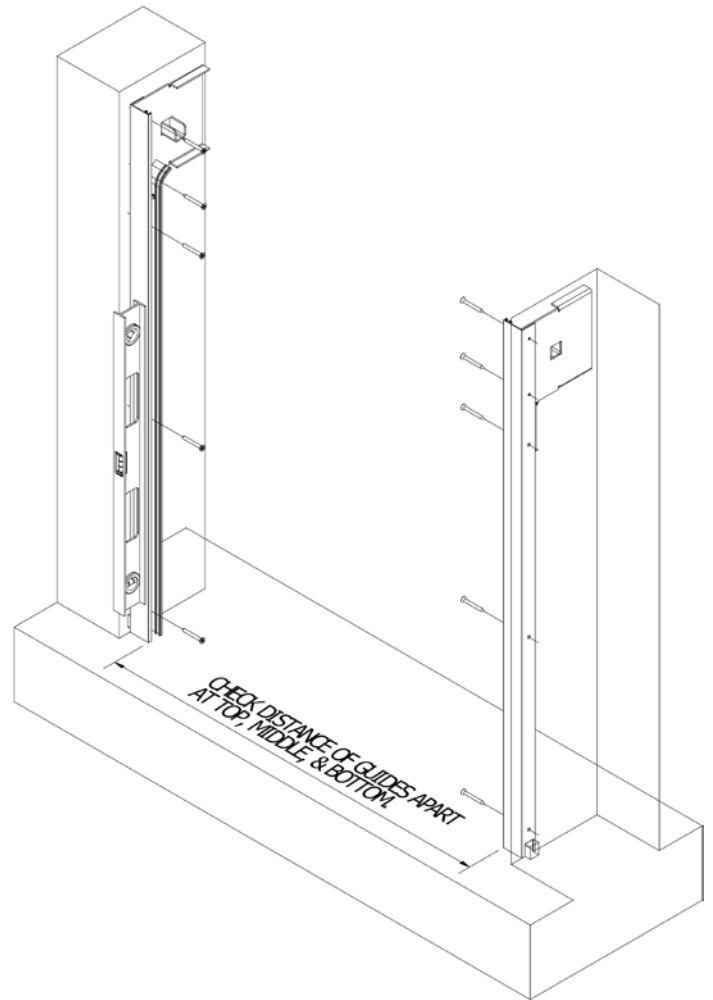

BETWEEN JAMB MOUNTING

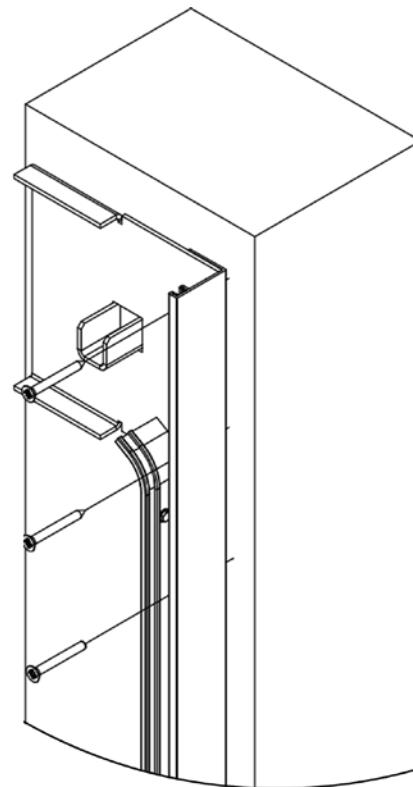
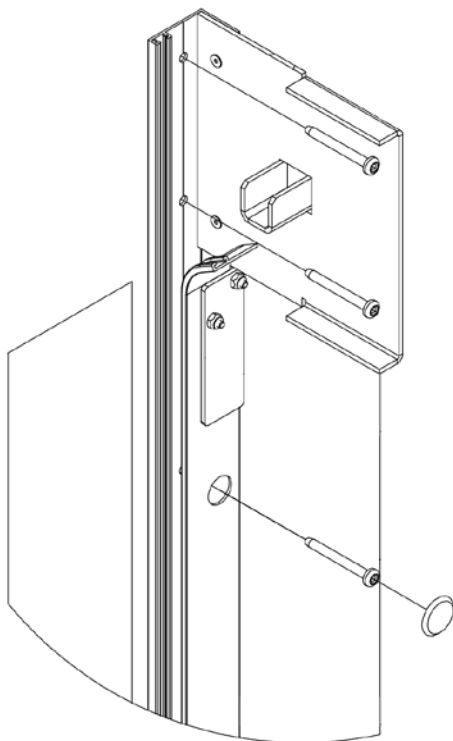

4

SET BARREL ASSEMBLY INTO THE BRACKET LUGS. CHECK WITH INSTALLATION DRAWING TO ENSURE THE TENSION ADJUSTING END IS ON THE CORRECT SIDE AND THAT THE BARREL IS INSTALLED IN THE CORRECT ORIENTATION. YOU CAN VERIFY THIS AGAINST THE LABEL ON THE BARREL.

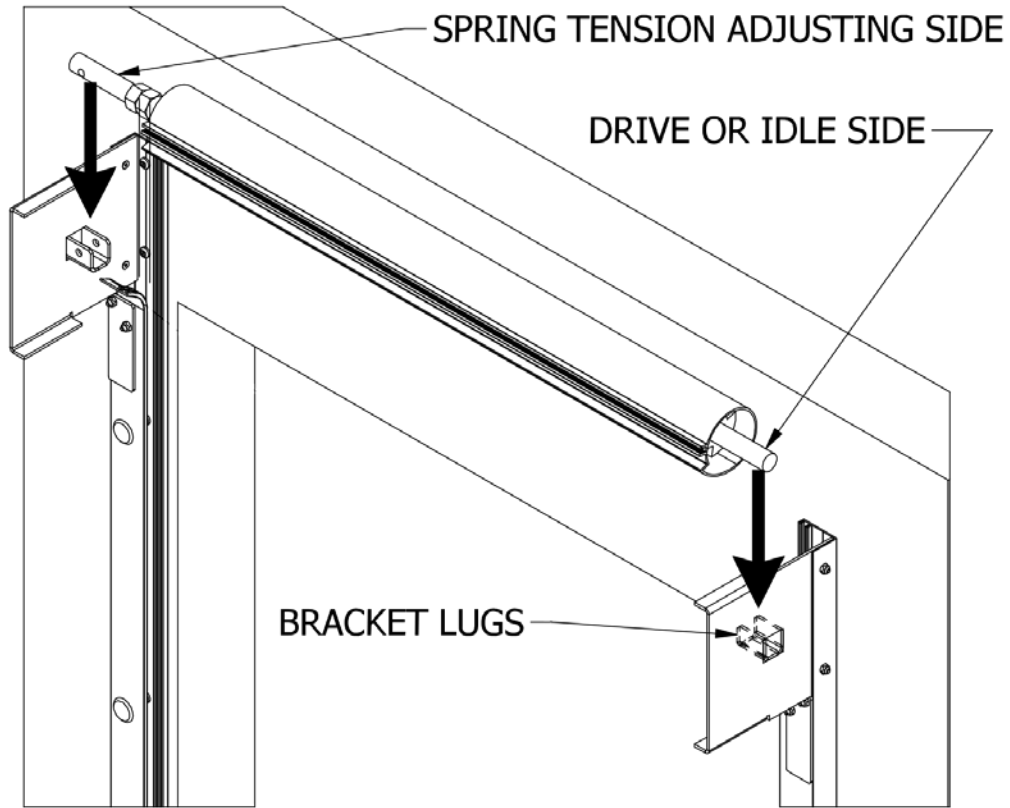

5

INSTALL CURTAIN INTO GUIDES. FEED CURTAIN OVER THE BARREL AND INTO DOWN INTO THE GUIDES.

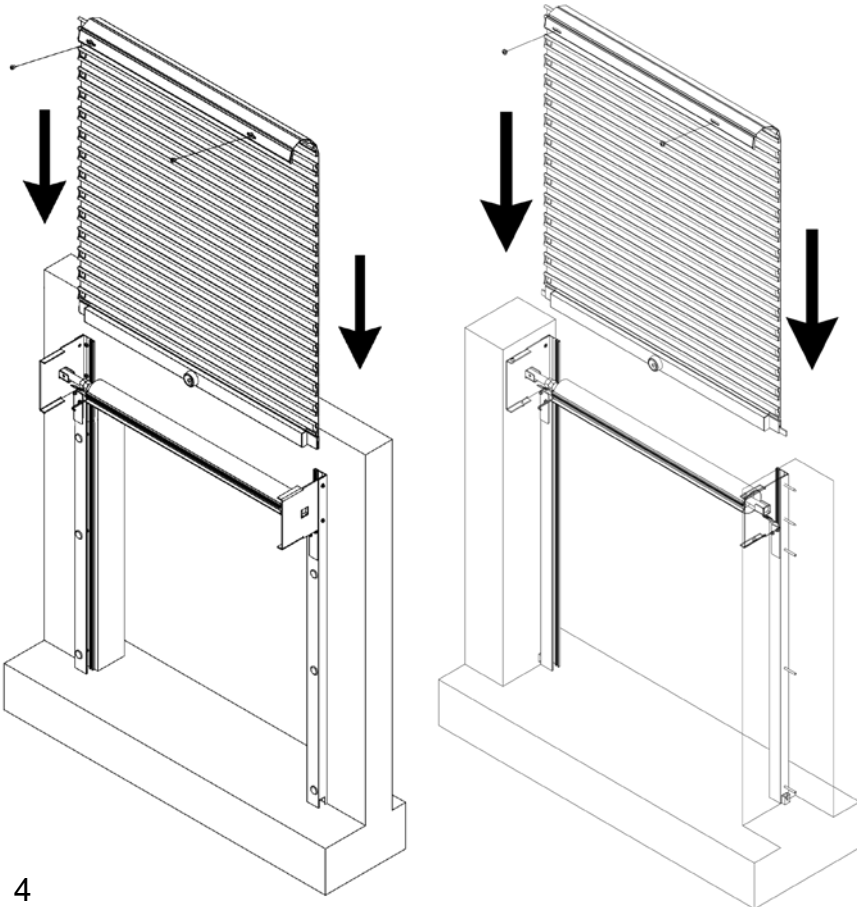

6

POSITION CURTAIN EVENLY BETWEEN BRACKETS, THEN FASTEN STARTER SLAT TO THE BARREL WITH 5/32 ALLEN KEY.

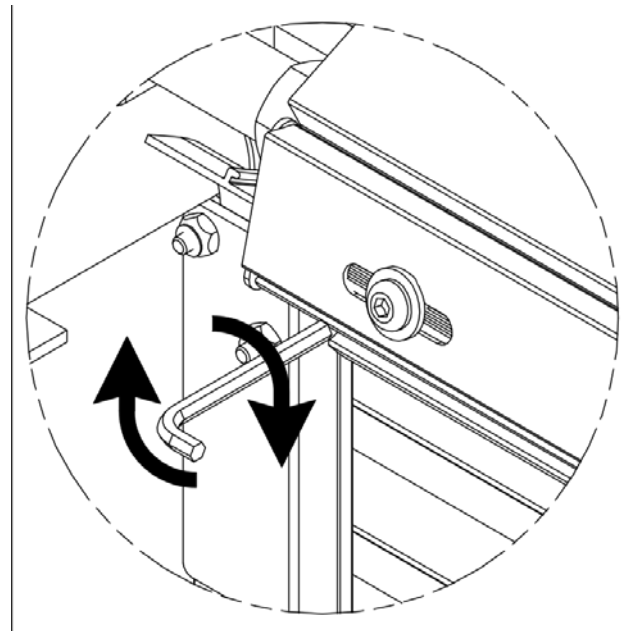

7 REMOVE PRE-INSTALLED NUTS AND REPOSITION BOTH STOPPERS SO THAT THEY ARE PERPENDICULAR TO THE GUIDES. RE-INSTALL NUTS TO SECURE STOPPERS IN PLACE.

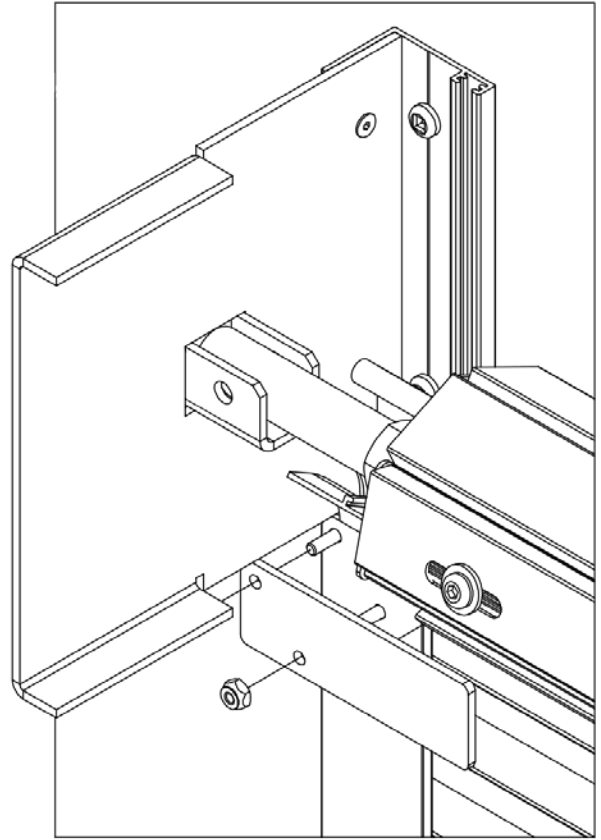
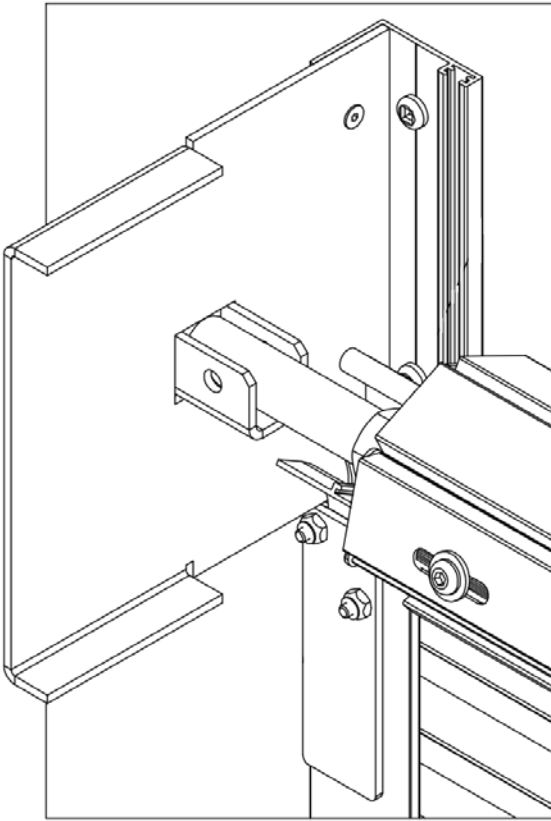

8 SET SPRING TENSION BY ALTERNATING BETWEEN TWO 3/4" WRENCHES, ROTATE THE ADJUSTER NUTS FOR THE AMOUNT OF TURNS INDICATED ON THE INSTALL SHEET AND IN THE DIRECTION INDICATED ON THE BARREL LABEL.

8.1 ONCE YOU HAVE REACHED THE INTENDED NUMBER OF TURNS, INSERT THE SPRING TENSION BOLT THROUGH THE HOLES IN THE BRACKET LUG AND THROUGH THE HOLE IN THE SHAFT, FASTEN TENSION BOLT SECURELY IN PLACE WITH NUT.



IMPORTANT: ONLY RELEASE PRESSURE FROM THE WRENCHES/TENSIONING BARS AFTER YOU HAVE INSTALLED AND SECURED THE TENSION BOLT IN PLACE.

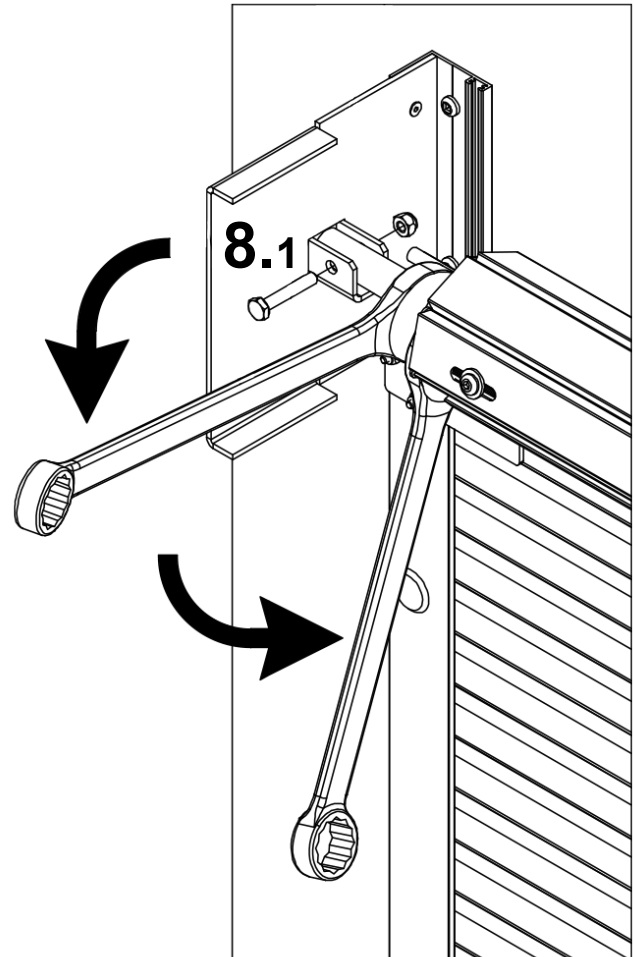

9 TEST THE SHUTTER OPERATION FOR PROPER BALANCE, ADJUST AS NEEDED.

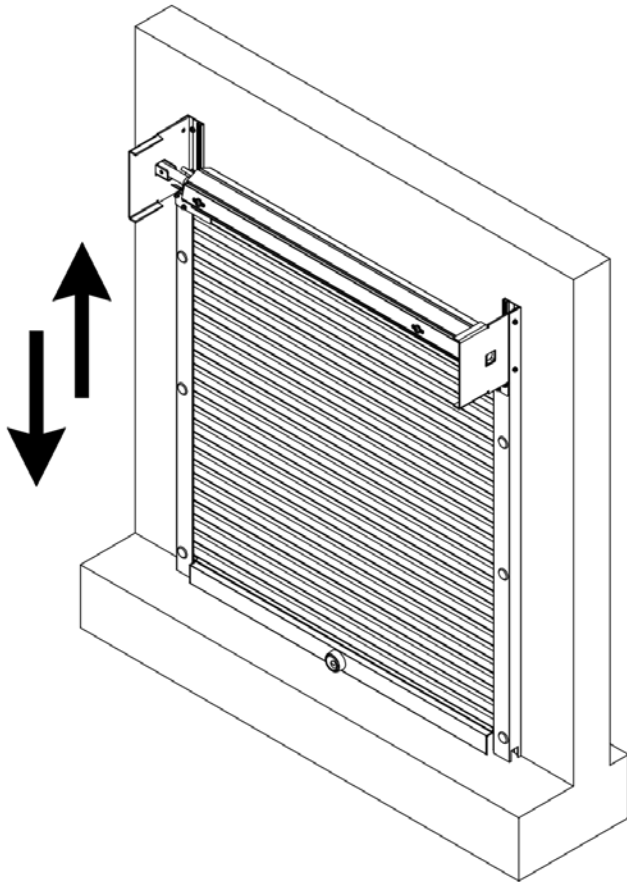

10 CHECK LOCKING OPERATION OF THE BOTTOM BAR. THE LOCK BAR MUST EXTEND PAST THE NOTCH LOCATED AT THE BOTTOM OF THE GUIDES.

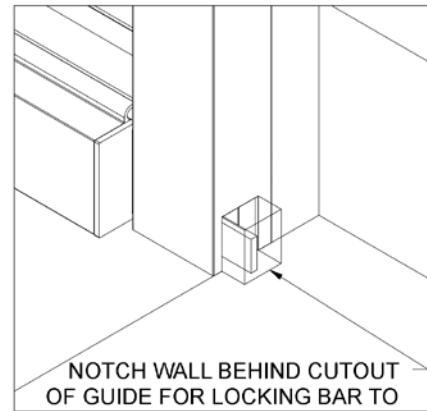
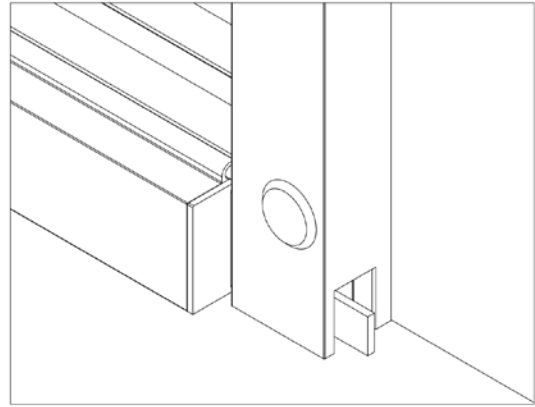

11 TO FINISH THE INSTALLATION, INSTALL THE ALUMINUM HOOD BY DRILLING AN 11/64" PILOT HOLE AND FASTENING THE HOOD TO THE BRACKET PLATE WITH THE SUPPLIED #10-24X1/2" SELF THREADING SCREWS.

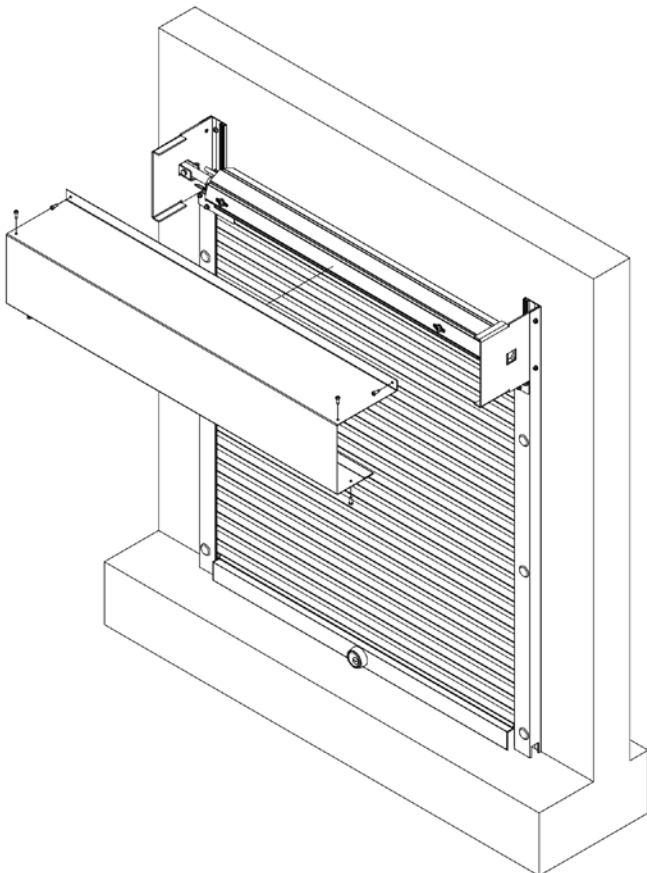

FACE OF WALL MOUNTING

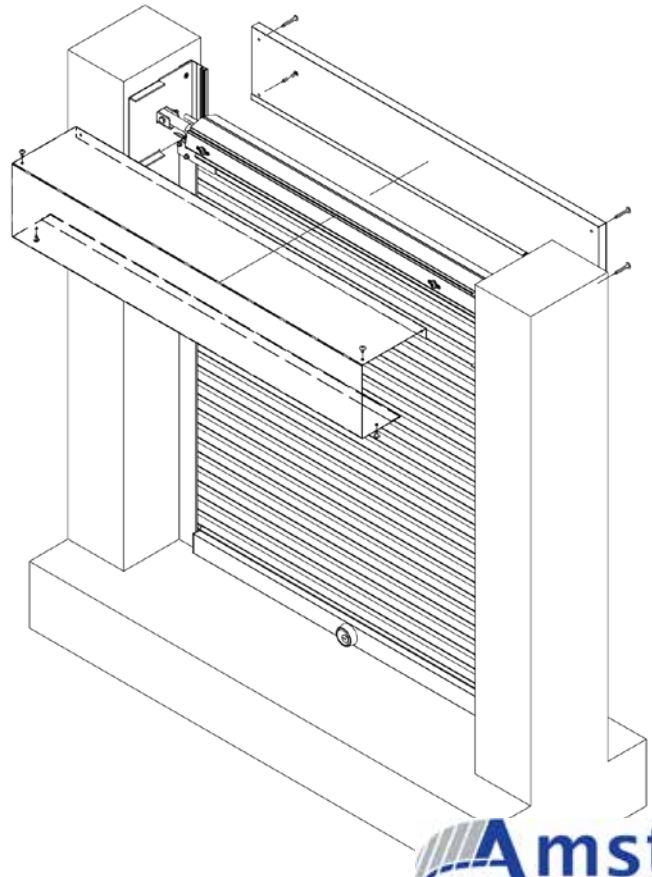

BETWEEN JAMB MOUNTING

MAINTENANCE SCHEDULE

Below is a list of the door components for inspection and maintenance. Maintenance should be completed by a trained door technician.



WARNING:

Any damages, adjustments, and repairs should be completed by a trained door technician. Any replacement parts must be provided by the manufacturer and not interchanged with other manufacturers products.

Components for Inspection	Each Use	Quarterly	Annually
Visual inspections			
Any damage to the curtain or end caps?	•		
Any damage to the bottom bar?	•		
Any damage of the hood or fascia?	•		
Any damage to the guides?	•		
Any damage to the bracket plates?	•		
Fastener Inspections			
Are the fasteners holding the guides to the wall properly tightened?		•	
Are the fasteners holding the bracket plates to the guides properly tightened?		•	
Are there any missing fasteners present?		•	
Is the tension bolt properly tightened?		•	
Are all the fasteners present that hold the hood and fascia in place?		•	
Mechanical Inspections			
Is the bottom bar locking and unlocking properly?	•		
Is the balance on the shutter correct?			•
Double check that all the installation dimensions are accurate against the as built drawings.			•
Wear Inspection			
Are there any signs of wear on the bracket plates from the slats rubbing on it?			•
Are the guide wear strips still present and in good form?			•
Do the slats show any signs of wear from the guide throats?			•